



DORSETT
PUTRAJAYA



LOCATION

The midscale 218 guestrooms Dorsett Putrajaya is located within Malaysia's federal administrative capital. The hotel is within walking distance to key Malaysian government offices such as the National Registration Department, Custom Department, Ministry of Health, Ministry of Entrepreneurship and the Federal Court of Malaysia. Other places of interest include the Masjid Tuanku Mizan Zainal Abidin (Silver Mosque); Monument Alaf Baru (Millennium Monument) and Taman Wawasan.

With the Putrajaya ERL Station just a mere 10-minute drive away and only 30-minute drive to Kuala Lumpur International Airport, Dorsett Putrajaya is the ideal address for leisure, business and conferences.



Dorsett Putrajaya
Lot 3 (Lot 3c5), Precinct 3, Bandar Putrajaya,
Wilayah Persekutuan, Putrajaya, Malaysia

T: +6 03 8892 8388 F: +6 03 8892 8288

www.dorsetthotels.com

Managed by Dorsett Hospitality International

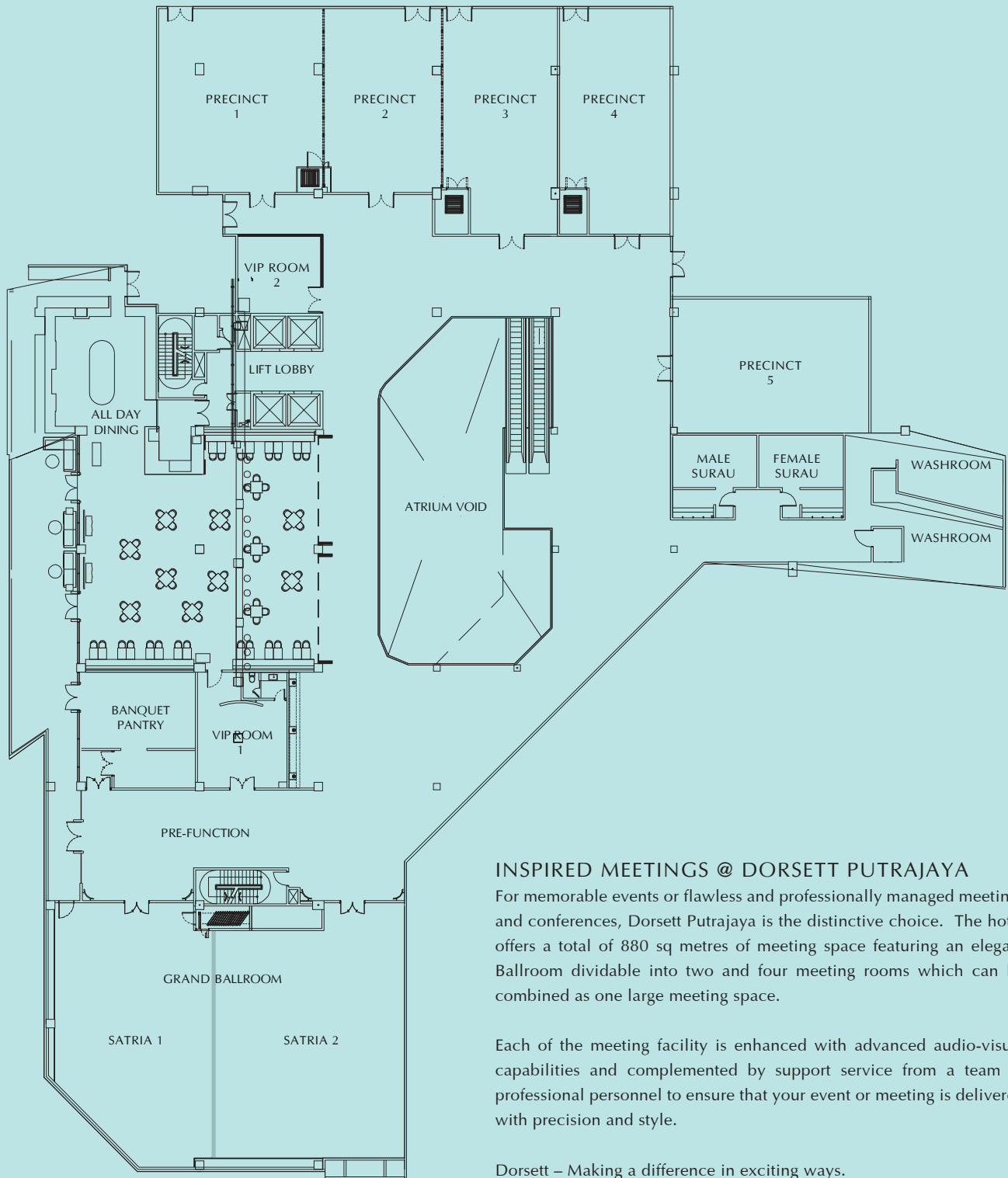

FUNCTION ROOM	AREA SQ METERS	BANQUET SEAT DOWN	BANQUET BUFFET	FISHBONE	CLASSROOM	THEATRE	USHAPE	STANDING COCKTAIL
Satria Ballroom		300	230	219	240	410	90	220
Satria 1	219.3	130	90	63	72	120	33	80
Satria 2	179.4	160	110	99	90	168	45	140
Precinct 1	119	80	50	45	45	92	33	45
Precinct 2	119	60	30	45	45	72	33	35
Precinct 3	103	60	30	45	45	72	33	35
Precinct 4	141	60	30	45	45	84	33	40
Precinct 5	140	60	30	45	45	84	33	45
Precinct Room	482	260	190	126	126	320	160	160
Precinct 1 & 2	225	140	90	90	90	164	54	80
Precinct 2 & 3	245	120	70	90	90	144	54	70
Precinct 3 & 4	245	120	70	90	90	156	54	75
Poolside	165.4	-	-	-	-	-	-	60